

ATTACHMENT C

**SELECTED PUBLIC DOMAIN PLANS
HAROLD PARK - STAGE 1**

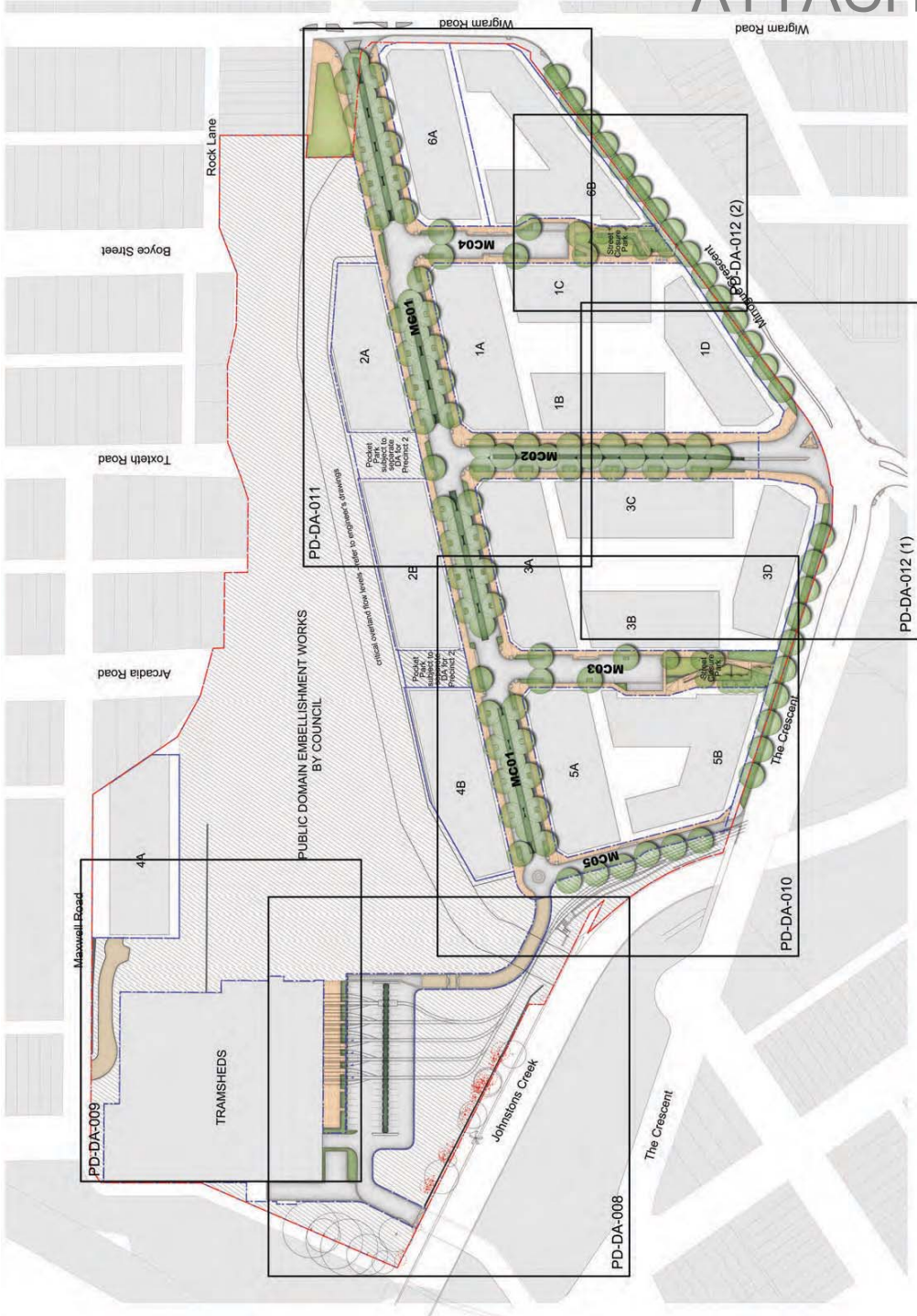

scale @ A3: 1:750
 job no: 11001
 date: 06/02/2012
 drawing no: PD-DA-001
 rev: D



NOTE:
 - Refer to engineering drawings for detailed levels and grading information.
 - Refer to lighting drawings for location of light poles.

Drawing No.	Drawing Name	Scale	Revision
DA-PD-001	Public Domain Cover Sheet	1:750	D
DA-PD-002	Analysis of Surrounding Open Space	NTS	D
DA-PD-003	Public Domain Extent Plan	1:500	D
DA-PD-004	Public Domain Delivery Plan	1:500	D
DA-PD-005	Indicative Through Site Links Plan	1:500	D
DA-PD-006	Street Tree Master Plan	1:500	E
DA-PD-007	Car park Entries, Loading Areas and Lobbies Plan	1:500	D
DA-PD-008	Public Footways Plan (1 of 5)	1:200	F
DA-PD-009	Public Footways Plan (2 of 5)	1:500	A
DA-PD-010	Public Footways Plan (3 of 5)	1:500	D
DA-PD-011	Public Footways Plan (4 of 5)	1:500	D
DA-PD-012	Public Footways Plan (5 of 5)	1:500	D
DA-PD-013	Typical Street Sections	1:50	C
DA-PD-014	MC03 Street Closure Park	As Shown	G
DA-PD-015	MC04 Street Closure Park	As Shown	A
DA-PD-016	Public Footways Typical Details (1 of 2)	As Shown	B
DA-PD-017	Public Footways Typical Details (2 of 2)	As Shown	B
DA-PD-018	Johnstons Creek Walkway Sections	As Shown	B
DA-PD-019	Tram Sheds Walls Sections	As Shown	B

Key
 --- Site Boundary
 --- Lot Boundary

Drawing List

project:
Harold Park
 Glebe, NSW

client:
 mirvac

architects in association:
 Mirvac Design
 Level 20, 80 Macquarie St
 Sydney NSW 2000
 Tel: 02 9228 0201
 Fax: 02 9228 0202
 MFR 78 292 291 926

public domain:
 ASPECT Studios
 Level 20, 80 Macquarie St
 Sydney NSW 2000
 Tel: 02 9228 0201
 Fax: 02 9228 0202
 MFR 78 292 291 926

title:
 Development Application
 Public Domain
 Cover Sheet

date:
 21/06/2012
 03/06/2012
 06/06/2012
 06/06/2012

rev:
 A Modified site layout and pocket parks
 B Additional drawings
 C CA Review
 D

author:
 CA Review

19/06/2012 11:02 AM

ATTACHMENT C

- City of Sydney LGA Boundary
- Harold Park
- Foreshore Park
- Local Park
- Pocket Park
- Sydney University Sport Fields
- Children's Playspaces
- Formal Planting Edges / Garden Beds
- Active Recreation Space
- Passive Recreation Space
- Public Facilities
- Recreation Network
- Sport Facilities
- Swimming Pool

Harold Park _ 10.6 ha _ 3.8ha of Public Open Space

1. Glebe Foreshore Parks
2. Jacksons Landing
3. Cadi Park
4. Pirrama Park and Pymont Point Park
5. Wentworth Park
6. Mary Ann Street Park
7. Victoria Park
8. Foley Park
- 9, 10. Local Park
11. End of Smith Hogan and Spindlers
12. Camperdown Park
13. O'Dea reserve
14. Hollis Park
15. Camperdown Memorial Rest Park
16. Weekly Playground
17. 36 Battalion Park
18. Pioneers Memorial Park
19. War Memorial Park
20. Whites Creek valley Park
21. Hinsby Park
22. Smith Hogan and Spindlers
23. Easton Park
24. Punch Park
25. Birrung and White bay Park
26. Fig Lane Park
27. McKee Street Playground

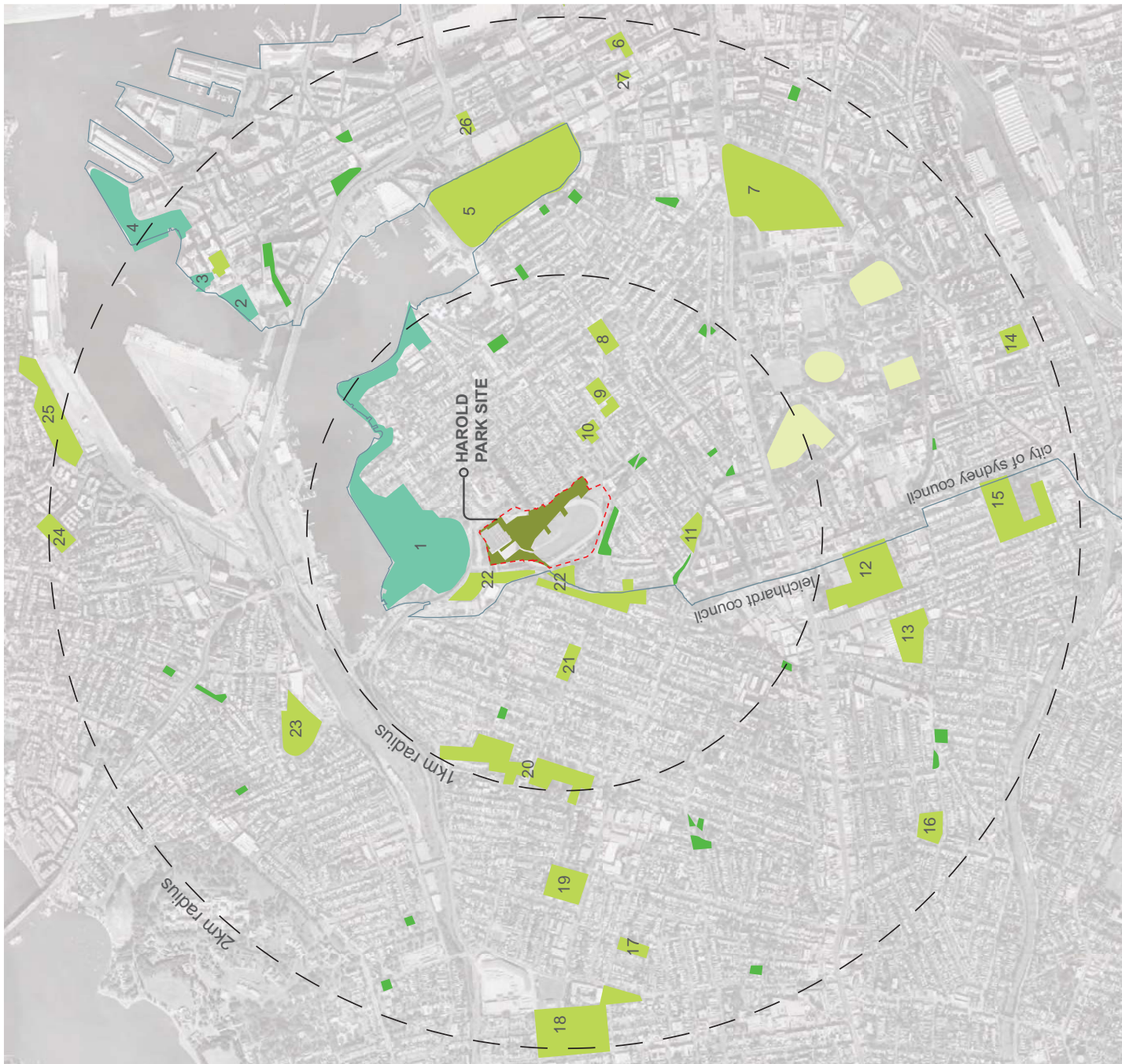

date: 21/06/2012
 rev: A
 amendment: 1. Finalized site layout and pocket parks
 2. Additional drawings
 3. CA issues
 4. U D

project: **Harold Park**
 Glebe, NSW
 Copyright of this design and all other information shown here is owned by Mirvac Design. No part of this design may be reproduced or transmitted in any form or by any means electronic or mechanical, including photocopying, recording, or by any information storage and retrieval system, without the written permission of Mirvac Design.

client: **mirvac**

architects in association:
Mirvac Design
 Level 21, 81 Market St
 Sydney NSW 2000
 Tel: 61 61 9228 8111
 Fax: 61 61 9228 8111
 ABR 19 200 291 95

landscape architects:
HASSELL
 Level 11, 100 Victoria Road
 Sydney NSW 2000
 Tel: 61 61 9228 8111
 Fax: 61 61 9228 8111
 ABR 19 200 291 95

public domain:
ASPECT Studios
 Level 11, 100 Victoria Road
 Sydney NSW 2000
 Tel: 61 61 9228 8111
 Fax: 61 61 9228 8111
 ABR 19 200 291 95

title: **Development Application**
Analysis of Surrounding
Open Spaces

job no: 11001
 date: 16/06/2012
 scale @ A4: As Shown
 drawing no: PD-DA-002
 rev: D



ATTACHMENT C

scale @ A0: 1:500
rev: D

date: 16/06/2012
job no: 11001
drawing no: PD-DA-003

ASPECT Studios
Public Domain
Extent Plan

Development Application
Public Domain
Extent Plan

HASSELL

Mirvac Design

mirvac

Harold Park
Glebe, NSW

Public Open Space - 3.8 ha

19/06/2012 11:02 AM



Key

- Public Open Space - 3.8 ha

date	revision	description
21/06/2011	A	Initial design layout and pocket paths
03/09/2011	C	Additional drawings
16/06/2012	D	CA issues

ATTACHMENT C



scale @ A3: 1:500
rev: D

date: 16/06/2012
job no: 11001
drawing no: PD-DA-004

title: Development Application
Public Domain
Delivery Plan

public domain:
ASPECT Studios

architects in association:
Mirvac Design
Mirvac
Level 20, 100 Macquarie Street
Sydney NSW 2000
Tel: 61 2 9268 8000
Fax: 61 2 9268 8001
www.mirvac.com.au
MIRVAC DESIGN IS AN AFFILIATE OF MIRVAC GROUP

architects in association:
HASSELL
Level 10, 100 Macquarie Street
Sydney NSW 2000
Tel: 61 2 9268 8000
Fax: 61 2 9268 8001
www.hassell.com.au
HASSELL IS AN AFFILIATE OF MIRVAC GROUP

architects in association:
Mirvac Design
Mirvac
Level 20, 100 Macquarie Street
Sydney NSW 2000
Tel: 61 2 9268 8000
Fax: 61 2 9268 8001
www.mirvac.com.au
MIRVAC DESIGN IS AN AFFILIATE OF MIRVAC GROUP

architects in association:
Mirvac Design
Mirvac
Level 20, 100 Macquarie Street
Sydney NSW 2000
Tel: 61 2 9268 8000
Fax: 61 2 9268 8001
www.mirvac.com.au
MIRVAC DESIGN IS AN AFFILIATE OF MIRVAC GROUP

client:
mirvac

project:
Harold Park
Glebe, NSW
Copyright © 2012 Mirvac Group
All rights reserved. No part of this document may be reproduced without the written permission of Mirvac Group.

date: 21/06/2012
rev: A
amendment:
A - Finalized site layout and finished plans
B - Additional drawings
C - CA Stage
D - CA Stage

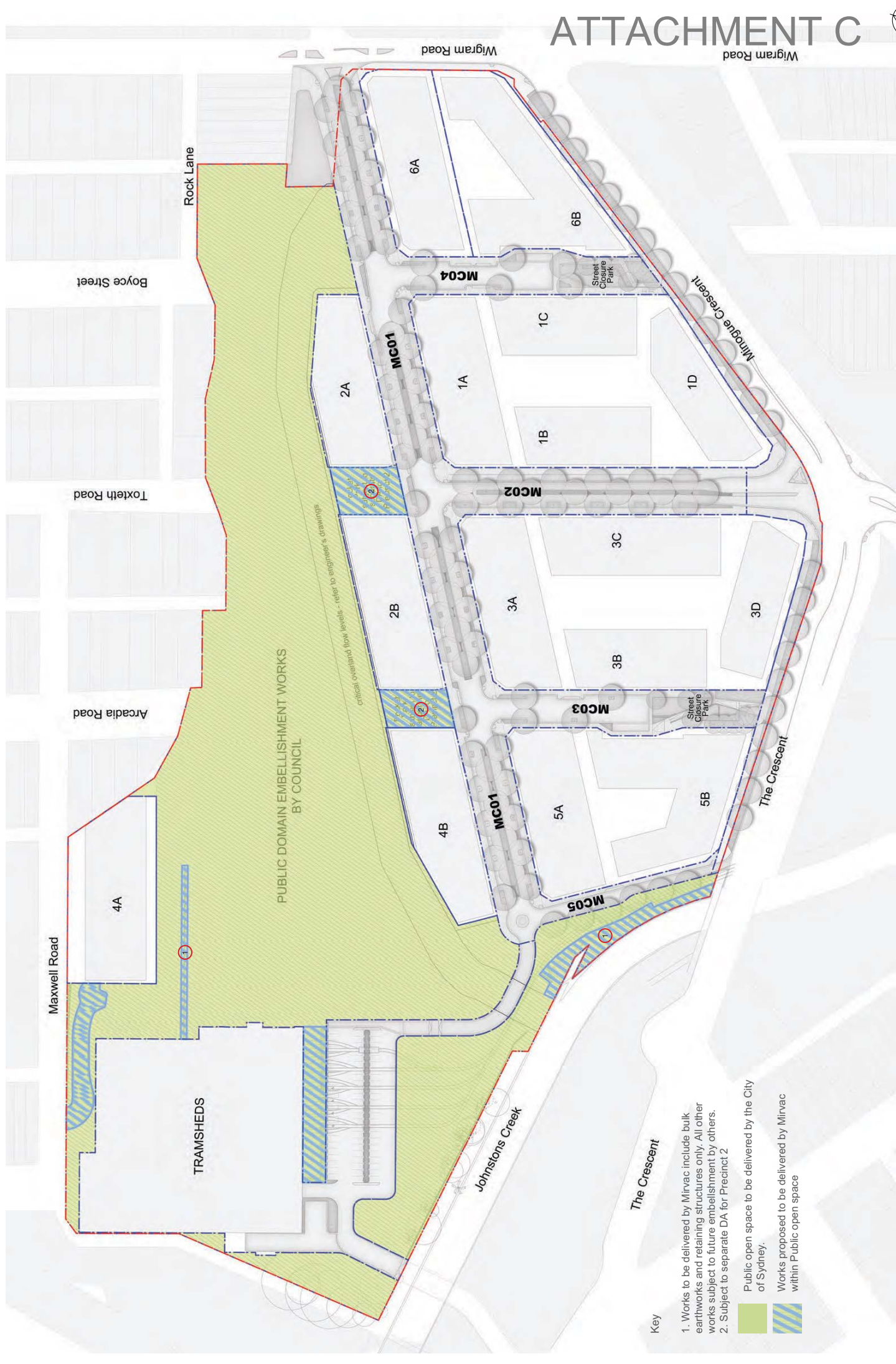

- Key**
- 1. Works to be delivered by Mirvac include bulk earthworks and retaining structures only. All other works subject to future embellishment by others.
 - 2. Subject to separate DA for Precinct 2
 - Public open space to be delivered by the City of Sydney.
 - Works proposed to be delivered by Mirvac within Public open space

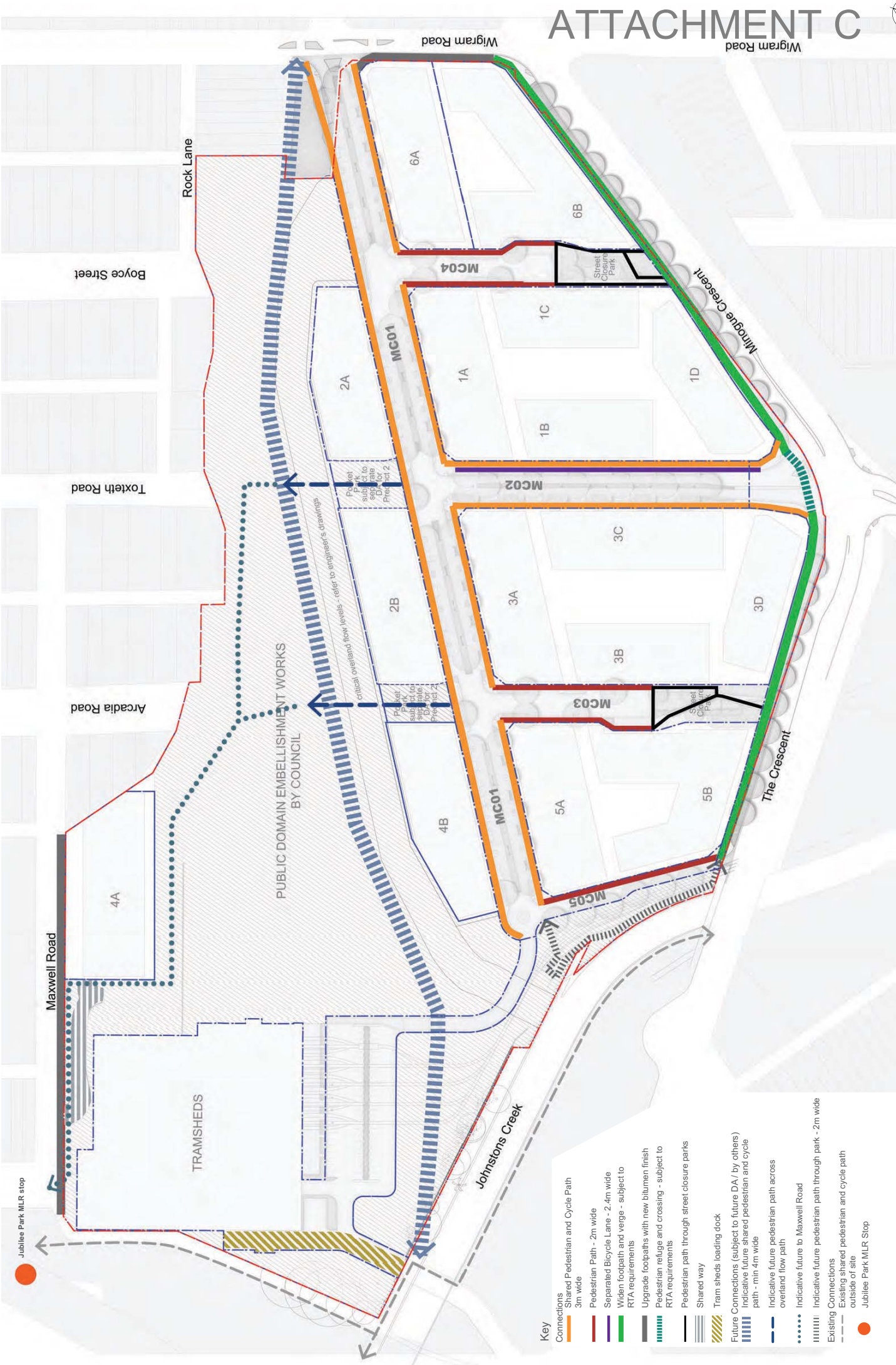

- Key**
- Connections
 - Shared Pedestrian and Cycle Path - 3m wide
 - Pedestrian Path - 2m wide
 - Separated Bicycle Lane - 2.4m wide
 - Widened footpath and verge - subject to RTA requirements
 - Upgrade footpaths with new bitumen finish
 - Pedestrian refuge and crossing - subject to RTA requirements
 - Pedestrian path through street closure parks
 - Shared way
 - Tram sheds loading dock
 - Future Connections (subject to future DA / by others)
 - Indicative future shared pedestrian and cycle path - min 4m wide
 - Indicative future pedestrian path across overland flow path
 - Indicative future to Maxwell Road
 - Indicative future pedestrian path through park - 2m wide
 - Existing Connections
 - Existing shared pedestrian and cycle path outside of site
 - Jubilee Park MLR Stop

PUBLIC DOMAIN EMBELLISHMENT WORKS
BY COUNCIL

critical overland flow levels - refer to engineer's drawings

Pocket park to separate D for Plot 2

Pocket park to separate D for Plot 2

Pocket park to separate D for Plot 2

Pocket park to separate D for Plot 2

Pocket park to separate D for Plot 2

Pocket park to separate D for Plot 2

Pocket park to separate D for Plot 2

Pocket park to separate D for Plot 2

Pocket park to separate D for Plot 2

Pocket park to separate D for Plot 2

Pocket park to separate D for Plot 2

Pocket park to separate D for Plot 2

Pocket park to separate D for Plot 2

Pocket park to separate D for Plot 2

Pocket park to separate D for Plot 2

Pocket park to separate D for Plot 2

Pocket park to separate D for Plot 2

Pocket park to separate D for Plot 2

Pocket park to separate D for Plot 2

Pocket park to separate D for Plot 2

Pocket park to separate D for Plot 2

Pocket park to separate D for Plot 2

Pocket park to separate D for Plot 2

Pocket park to separate D for Plot 2

Pocket park to separate D for Plot 2

Pocket park to separate D for Plot 2

Pocket park to separate D for Plot 2

Pocket park to separate D for Plot 2

Pocket park to separate D for Plot 2

Pocket park to separate D for Plot 2

Pocket park to separate D for Plot 2

Pocket park to separate D for Plot 2

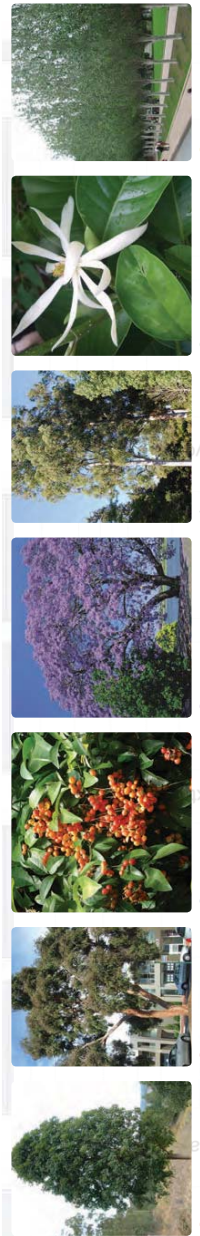

- Flindersia australis
- Angophora costata
- Harpullia pendula
- Jacaranda mimosifolia
- Eucalyptus saligna
- Michelia x alba
- Populus simonii

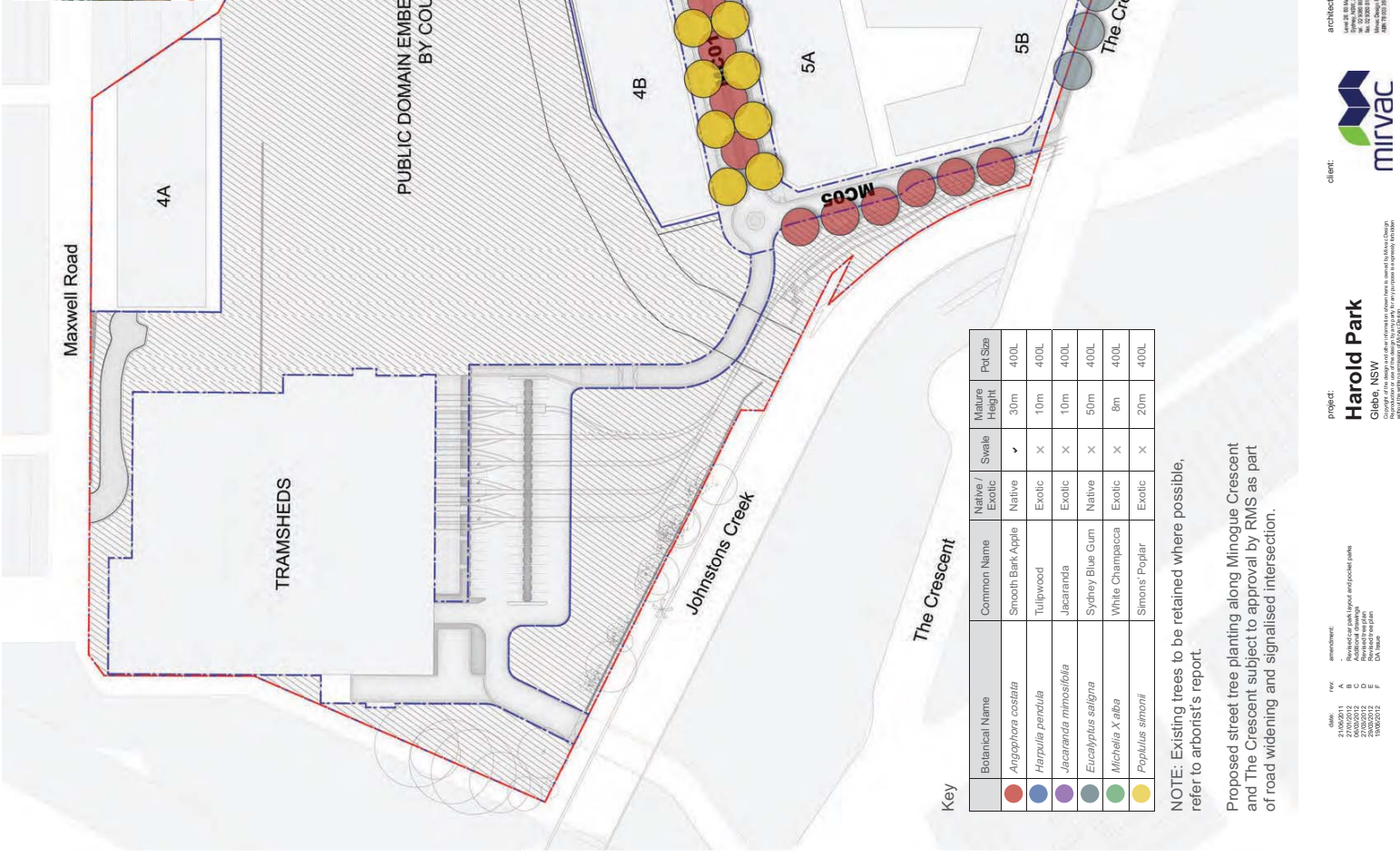

Botanical Name	Common Name	Native / Exotic	Shade / Svalve	Mature Height	Pat Size
Angophora costata	Smooth Bark Apple	Native	✓	30m	400L
Harpullia pendula	Tulipwood	Exotic	X	10m	400L
Jacaranda mimosifolia	Jacaranda	Exotic	X	10m	400L
Eucalyptus saligna	Sydney Blue Gum	Native	X	50m	400L
Michelia x alba	White Champacca	Exotic	X	8m	400L
Populus simonii	Simons' Poplar	Exotic	X	20m	400L

NOTE: Existing trees to be retained where possible, refer to arborist's report.

Proposed street tree planting along Minogue Crescent and The Crescent subject to approval by RMS as part of road widening and signalised intersection.

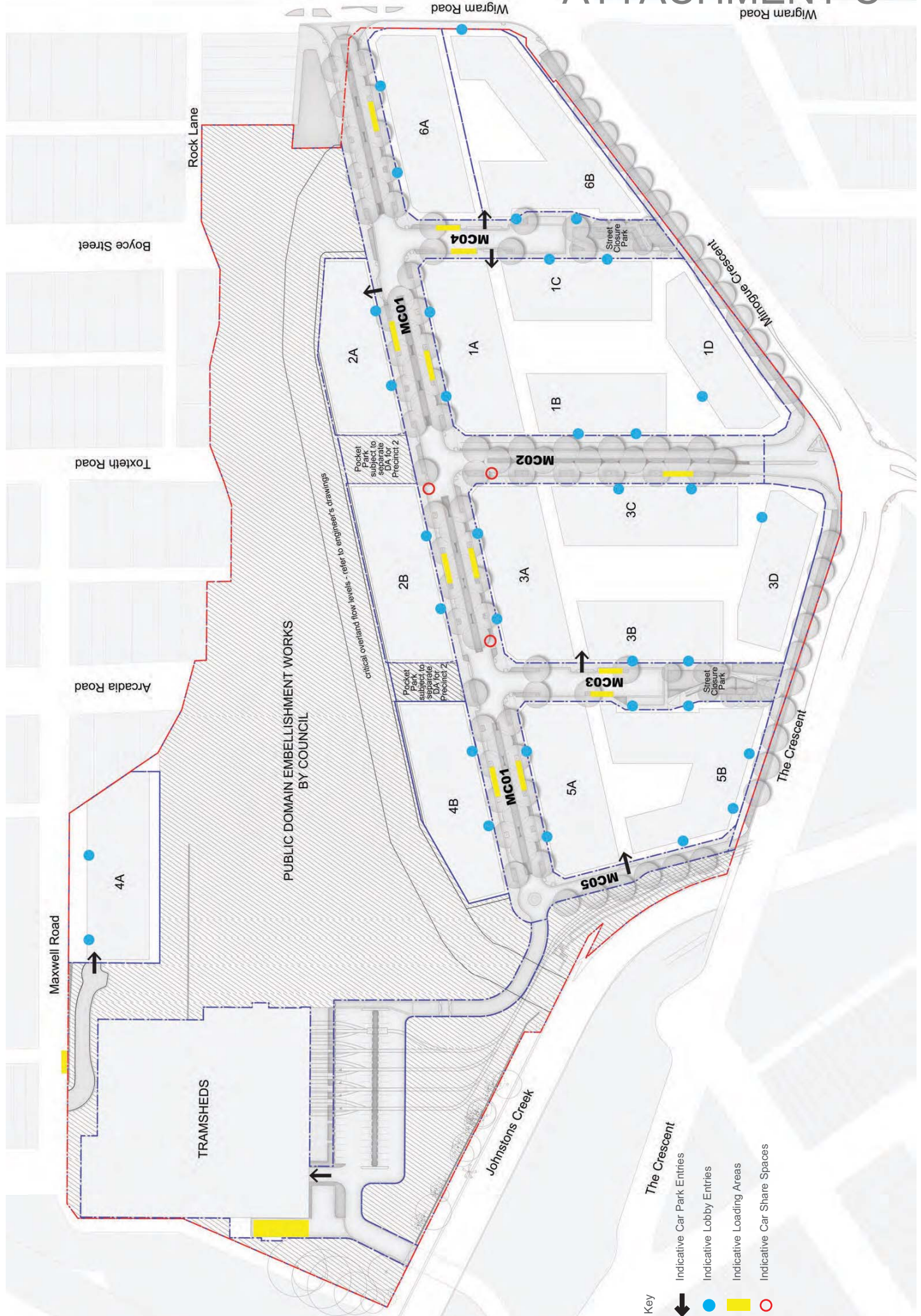

- Key**
- ➔ Indicative Car Park Entries
 - Indicative Lobby Entries
 - Indicative Loading Areas
 - Indicative Car Share Spaces

ATTACHMENT C

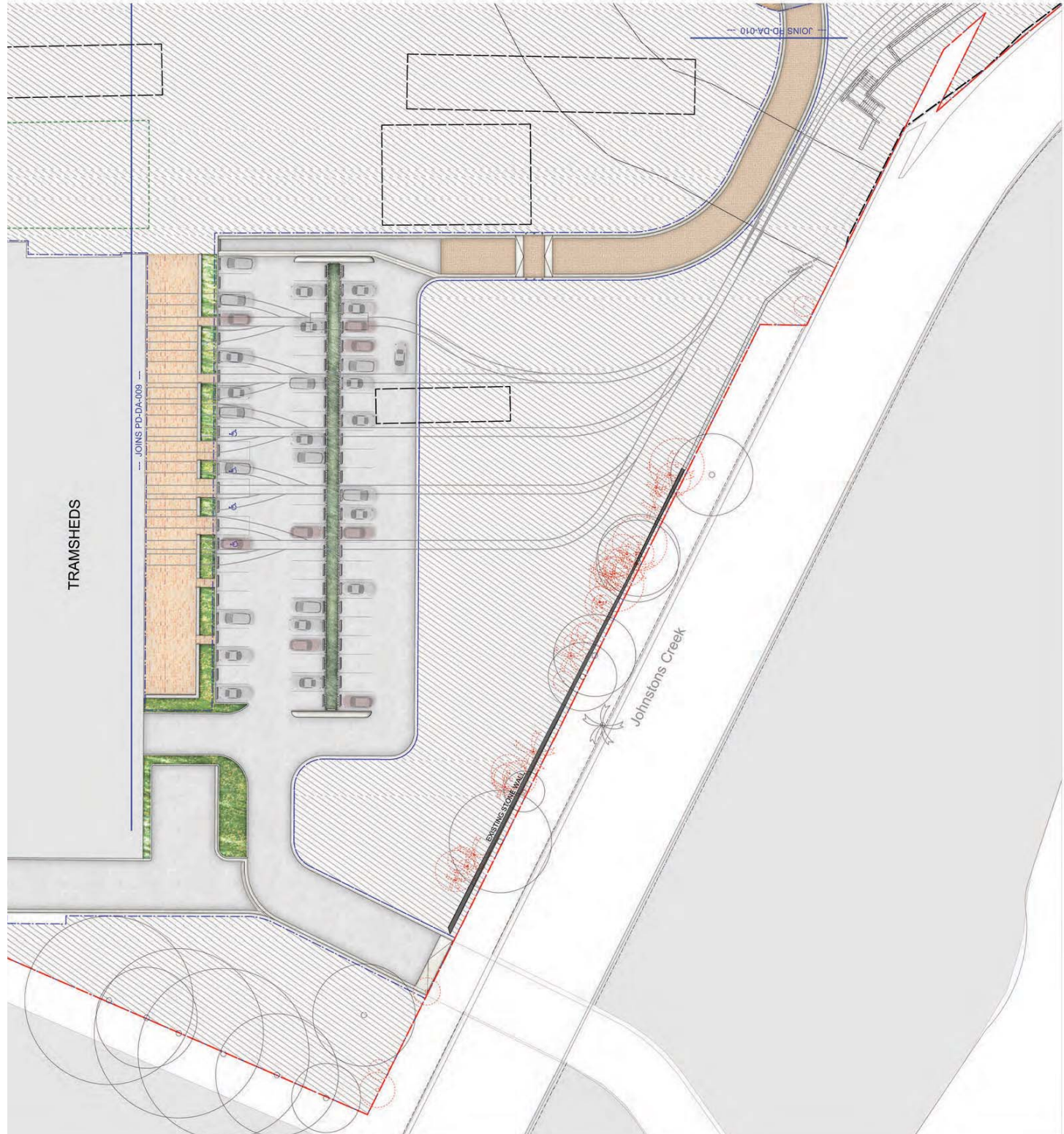

Key

	Site Boundary		Turf
	Lot Boundary		In situ concrete stair with stainless steel handrails
	Existing tree to be retained		In situ concrete ramp with stainless steel handrails
	Existing tree to be removed		Timber bench, 150mm high
	Proposed Tree		Concrete bench, 450mm high
	Asphalt carriageway		200mm Stainless Steel LEDA board - refer to 02/PD-DA-016
	Brick paving to footpaths - refer to 05/PD-DA-016		City of Sydney bike racks - refer to 01/PD-DA-016
	Concrete paving - refer to 06/PD-DA-016		Existing stone wall
	Interlocking concrete unit pavers to share ways - refer to 05/PD-DA-016		Existing heritage handrail
	Brick paved cycle path, 150mm set down - refer to 05/PD-DA-016		Former tram line interpretation - refer to 07-11/PD-DA-016
	On street parking bay with asphalt paving, concrete kerb and gutter		Indicative footprints of former buildings
	Disabled parking bay		Opportunity for locating heritage garden - part of council embellishment works
	Concrete pedestrian and vehicular kerb crossovers - refer to 03/PD-DA-017		Indicative existing location of heritage water tower (to be temporarily stored then relocated)
	Matted planting		Proposed location for relocated heritage water tower
	Rain garden with precast concrete wheel stops - refer to 01/PD-DA-017		
	Central swale with permeable concrete kerb - refer to 02/PD-DA-017		

NOTE:
 - Refer to engineering drawings for detailed levels and grading information.
 - Refer to lighting drawings for location of light poles.
 - Street furniture to be located throughout streets where appropriate. Refer to PD-DA-016 for selected furniture.

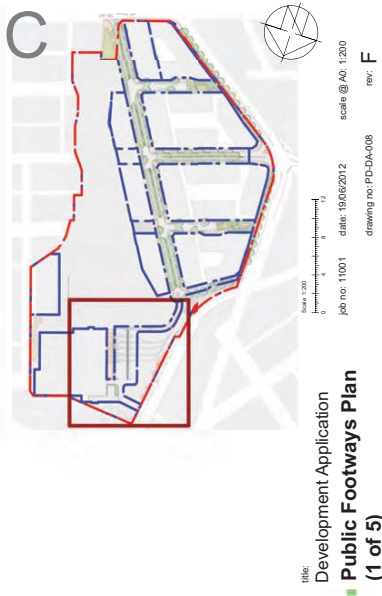

project: Harold Park Glebe, NSW
 Copyright of this design and all other information herein reserved. owned by Mirvac Design. Refer to the site nomination of Mirvac Design.

client: mirvac

architects in association:
 Lead: Dr. Margaret B. ...
 Mirvac Design architects
 Mirvac Design

public domain:
 ASPECT Studios
 HASSSELL
 mirvac

date:
 21/06/2011
 18/07/2011
 11/08/2011
 02/09/2011
 16/09/2011

rev:
 A
 B
 C
 D
 E
 F

amendment:
 A - amended for final layout
 B - amended paving
 C - additional 300mm concrete
 D - amended
 E - amended

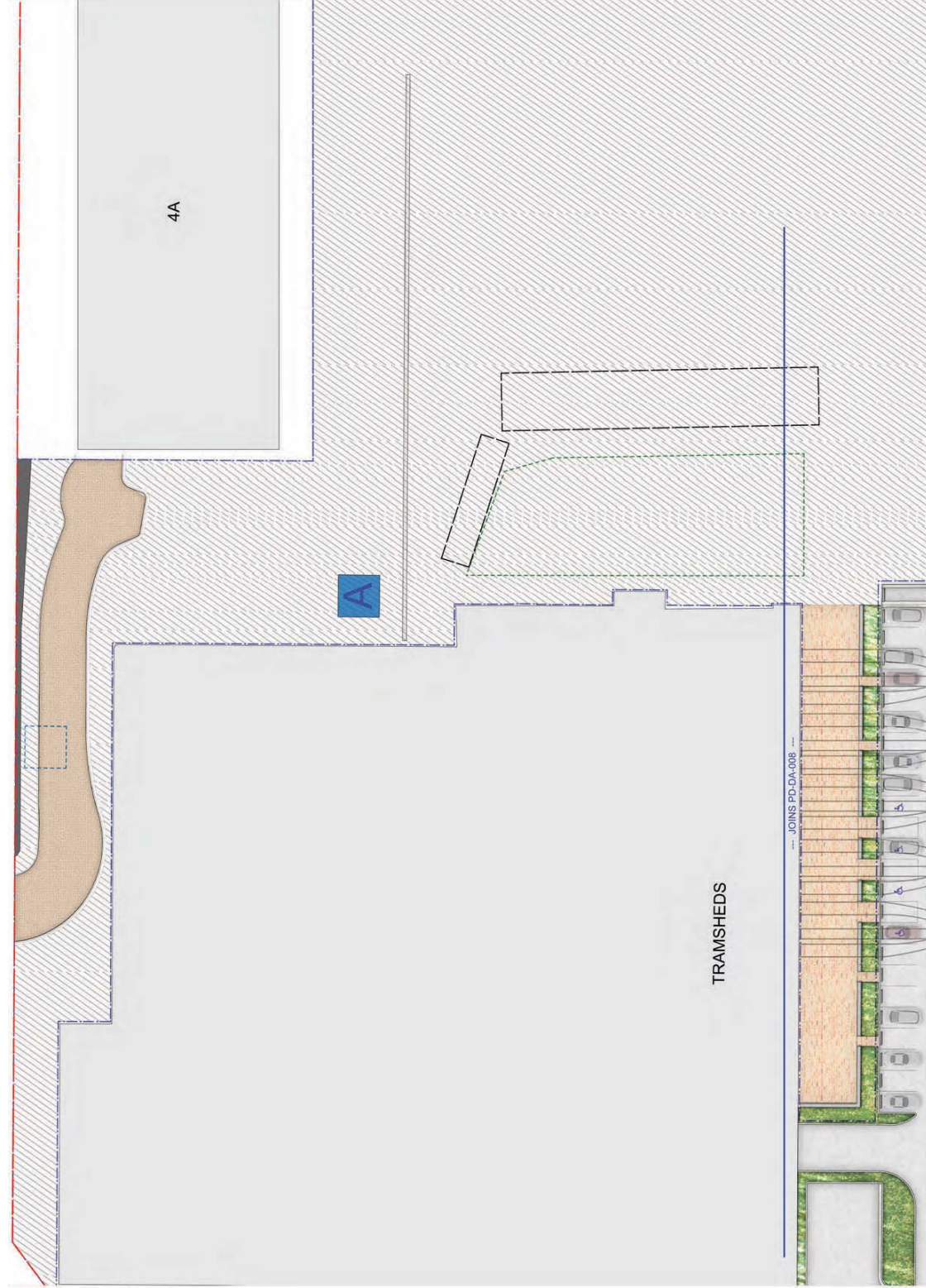

Key

- List of symbols and materials including Site Boundary, Lot Boundary, Existing tree to be retained, Proposed Tree, Asphalt carriageway, Concrete paving, Interlocking concrete unit pavers, Brick paved cycle path, On street parking bay with asphalt paving, Disabled parking bay, Concrete pedestrian and vehicular kerb crossovers, Massed planting, Rain garden with precast concrete wheel stops, Central swale with permeable concrete kerb, Turf, In situ concrete stair with stainless steel handrails, In situ concrete ramp with stainless steel handrails, Timber bench, Concrete bench, 200mm Stainless Steel LEDA board, City of Sydney bike racks, Existing stone wall, Existing heritage handrail, Former tram line interpretation, Indicative footprints of former buildings, Opportunity for locating heritage garden, Indicative existing location of heritage water tower, Proposed location for relocated heritage water tower.

NOTE:
- Refer to engineering drawings for detailed levels and grading information.
- Refer to lighting drawings for location of light poles.
- Street furniture to be located throughout streets where appropriate. Refer to PD-DA-016 for selected furniture.

ATTACHMENT C



19/06/2012 11:02 AM
Project: Harold Park, Glebe, NSW
Date: 19/06/2012
Rev: A
Author: DA Team

Client: Harold Park, Glebe, NSW
Project: Harold Park, Glebe, NSW
Date: 19/06/2012
Rev: A
Author: DA Team

Architects in association: Mirvac Design
Architects: Mirvac Design
Address: Mirvac Design, Level 21, 80 Macquarie St, Sydney NSW 2000
Tel: 02 9988 8000
Fax: 02 9988 8111
WWW.MIRVACDESIGN.COM.AU

ASPECT Studios
Public Domain
Level 21, 80 Macquarie St, Sydney NSW 2000
Tel: 02 9988 8000
Fax: 02 9988 8111
WWW.ASPECTSTUDIOS.COM.AU

Development Application
Public Footways Plan
(2 of 5)
Title: Development Application
Job no: 11001
Date: 27/01/2012
Scale @ A0: 1:200
Drawing no: PD-DA-009
Rev: E

ATTACHMENT C

Key	
	Site Boundary
	Lot Boundary
	Existing tree to be retained
	Existing tree to be removed
	Proposed Tree
	Asphalt carriageway
	Brick paving to footpaths - refer to 05/PD-DA-016
	Concrete paving - refer to 06/PD-DA-016
	Interlocking concrete unit pavers to share ways - refer to 05/PD-DA-016
	Brick paved cycle path, 150mm set down - refer to 05/PD-DA-016
	On street parking bay with asphalt paving, concrete kerb and gutter
	Disabled parking bay
	Concrete pedestrian and vehicular kerb crossovers - refer to 03/PD-DA-017
	Massed planting
	Rain garden with precast concrete wheel stops - refer to 01/PD-DA-017
	Central swale with permeable concrete kerb - refer to 02/PD-DA-017
	Turf
	In situ concrete stair with stainless steel handrails
	In situ concrete ramp with stainless steel handrails
	Timber bench, 450mm high
	Concrete bench, 450mm high
	200mm Stainless Steel LEDA bollard - refer to 02/PD-DA-016
	City of Sydney bike racks - refer to 01/PD-DA-016
	Existing stone wall
	Existing heritage handrail
	Former tram line interpretation - refer to 07-11/PD-DA-016
	Indicative footprints of former buildings
	Opportunity for locating heritage garden - part of council embellishment works
	Indicative existing location of heritage water tower (to be temporarily stored then relocated)
	Proposed location for relocated heritage water tower

NOTE:
 - Refer to engineering drawings for detailed levels and grading information.
 - Refer to lighting drawings for location of light poles.
 - Street furniture to be located throughout streets where appropriate. Refer to PD-DA-016 for selected furniture.

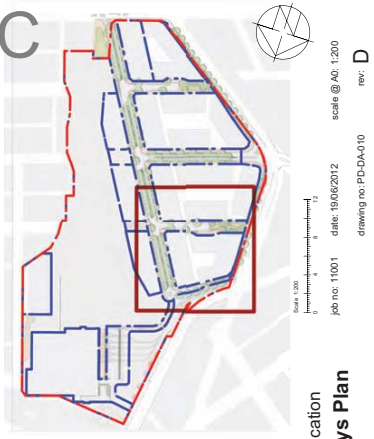

Scale: 1:500
 Job no: 11001
 Date: 06/06/2012
 Drawing no: PD-DA-010
 Scale @ A0: 1:200
 rev: D

public domain:
ASPECT Studios
 10/11-13/15 Market Street
 Sydney NSW 2000
 Tel: 02 9232 3000
 Fax: 02 9232 3002
 Email: info@aspectstudios.com.au

architects in association:
Mirvac Design
 Level 20, 80 Market Street
 Sydney NSW 2000
 Tel: 02 9232 3000
 Fax: 02 9232 3002
 Email: info@mirvacdesign.com.au

client:
mirvac

project:
Harold Park
 Glebe, NSW

date:
 21/06/2012
 06/06/2012
 06/06/2012
 06/06/2012

rev:
 A
 C
 D

amendment:
 A - Finalised site layout and finished paths
 B - Additional drawings
 C - Update
 D - Issue

Copyright © All rights reserved. All other rights reserved. owned by Mirvac Design. All other rights reserved. All other rights reserved. All other rights reserved. All other rights reserved.

NOTE:

- Refer to engineering drawings for detailed levels and grading information.
- Refer to lighting drawings for location of light poles.
- Street furniture to be located throughout streets where appropriate. Refer to PD-DA-016 for selected furniture.



Key

- Site Boundary
- Lot Boundary
- Existing tree to be retained
- Existing tree to be removed
- Proposed Tree
- Asphalt carriageway
- Concrete pedestrian and vehicular level crossovers - refer to 03/PD-DA-017
- Massed planting
- Rain garden with precast concrete wheel stops - refer to 01/PD-DA-017
- Central swale with permeable concrete kerb - refer to 02/PD-DA-017
- Turf
- In situ concrete stair with stainless steel handrails
- Brick paving to footpaths - refer to 05/PD-DA-016
- Concrete paving - refer to 06/PD-DA-016
- Interlocking concrete unit pavers to share ways - refer to 05/PD-DA-016
- Brick paved cycle path, 150mm set down - refer to 05/PD-DA-016
- On street parking bay with asphalt paving, concrete kerb and gutter
- Disabled parking bay
- In situ concrete ramp with stainless steel handrails
- Timber bench, 450mm high
- Concrete bench, 450mm high
- 200mm Stainless Steel LEDA bollard - refer to 02/PD-DA-016
- City of Sydney bike racks - refer to 01/PD-DA-016
- Existing stone wall
- Existing heritage handrail
- Former tram line interpretation - refer to 07-11/PD-DA-016
- Indicative footprints of former buildings
- Opportunity for locating heritage garden - part of council indicative existing location of heritage water tower (to be temporarily stored then relocated)
- Proposed location for relocated heritage water tower

client:

Harold Park
Glebe, NSW

project:

Harold Park
Glebe, NSW

architects in association:

mirvac

Mirvac Design

HASSELL

ASPECT Studios

Development Application
Public Footways Plan
(4 of 5)

date: 21/06/2011
rev: A
date: 03/08/2012
rev: C
date: 16/06/2012
rev: D

job no: 11001
scale @ A3: 1:200
drawing no: PD-DA-011

NOTE:

- Refer to engineering drawings for detailed levels and grading information.
- Refer to lighting drawings for location of light poles.
- Street furniture to be located throughout streets where appropriate. Refer to PD-DA-016 for selected furniture.

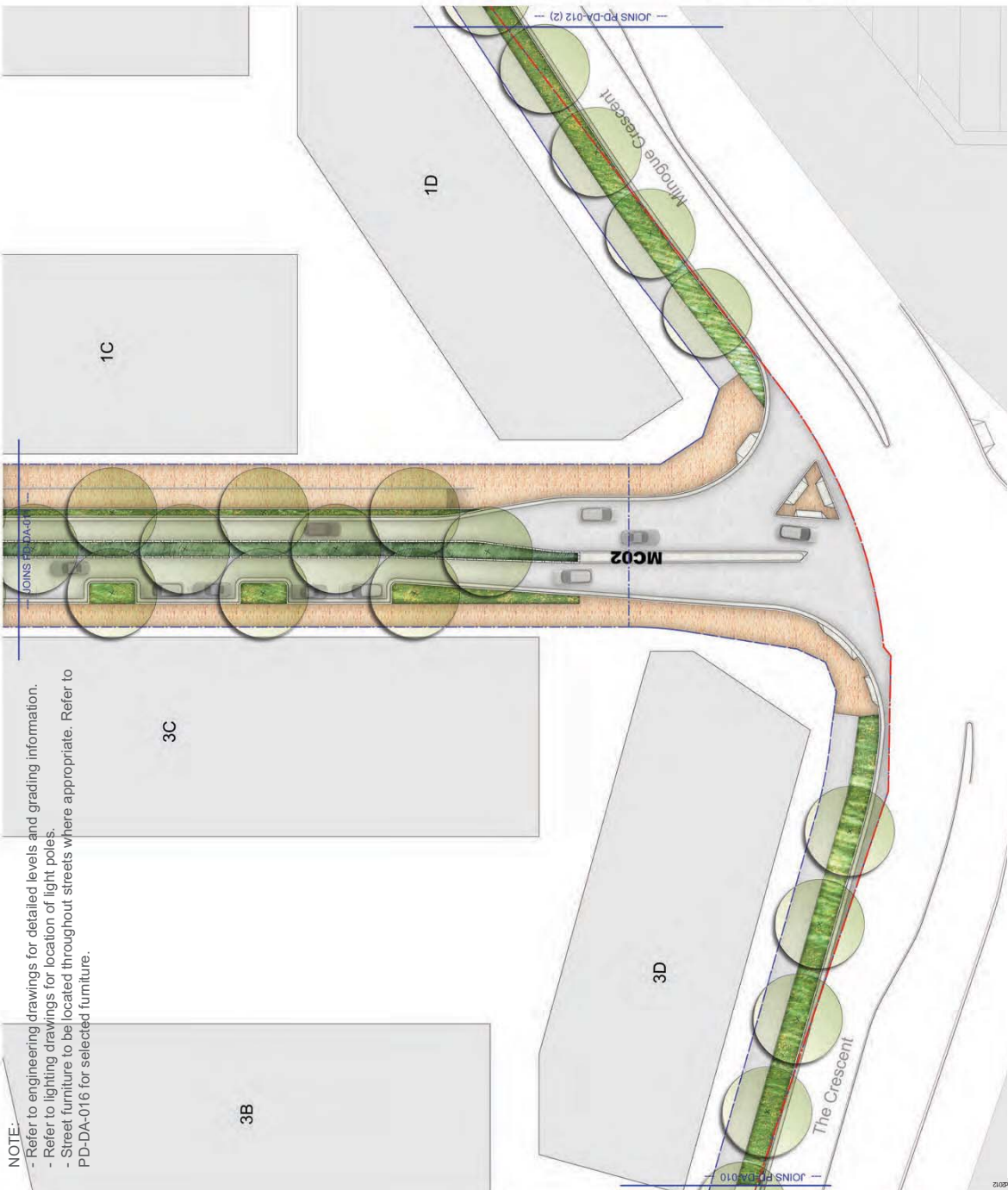

ATTACHMENT C

Key

- Site Boundary
- Lot Boundary
- Existing tree to be retained
- Existing tree to be removed
- Proposed Tree
- Asphalt carriageway
- Brick paving to footpaths - refer to 05/PD-DA-016
- Concrete paving - refer to 06/PD-DA-016
- Interlocking concrete unit pavers to share ways - refer to 05/PD-DA-016
- Brick paved cycle path, 150mm set down - refer to 05/PD-DA-016
- On street parking bay with asphalt paving, concrete kerb and gutter
- Disabled parking bay
- Concrete pedestrian and vehicular level crossovers - refer to 05/PD-DA-017
- Massed planting
- Rain garden with precast concrete wheel stops - refer to 01/PD-DA-017
- Central swale with permeable concrete kerb - refer to 02/PD-DA-017
- Turf
- In situ concrete stair with stainless steel handrails
- In situ concrete ramp with stainless steel handrails
- Timber bench, 450mm high
- Concrete bench, 450mm high
- 200mm Stainless Steel LEDA bollard - refer to 02/PD-DA-016
- City of Sydney bike racks - refer to 01/PD-DA-016
- Existing stone wall
- Existing heritage handrail
- Former tram line interpretation - refer to 07-11/PD-DA-016
- Indicative footprints of former buildings
- Opportunity for locating heritage garden - part of council heritage existing location of heritage water tower (to be temporarily stored then relocated)
- Proposed location for relocated heritage water tower

date: 21/06/2011
 rev: A
 03/06/2012
 06/06/2012
 16/06/2012

approved: [Signature]
 A
 C
 D

approved: [Signature]
 A
 C
 D

project:
Harold Park
 Glebe, NSW

client:
 Harold Park
 Glebe, NSW

architects in association:
mirvac

architects in association:
Mirvac Design

public domain:
ASPECT Studios

public domain:
HASSELL

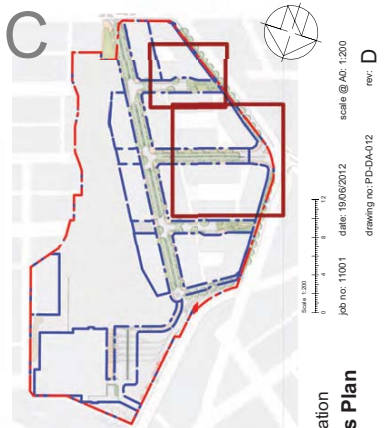

title:
**Development Application
 Public Footways Plan
 (5 of 5)**

scale @ A0: 1:200
 job no: 11001
 date: 06/06/2012
 drawing no: PD-DA-012
 rev: D

NOTE:
 Indicative mature trees shown at approximately 10 years after installation. Refer to Street Tree Master Plan for size at time of planting. Refer to lighting drawings for location of light poles.



- Key**
- 01 Local Street Type 1 MC01
 - 02 Local Street Type 2 MC02
 - 03 Local Street Type 3 + 4 MC03, MC04
 - 5A Local Street Type 5A - Two-Way MC05
 - 5B Local Street Type 5B - One-Way MC05
 - 06 Local Street Type 6 - Share Way MC06
 - 07 Upgrade to The Crescent and Minogue Crescent

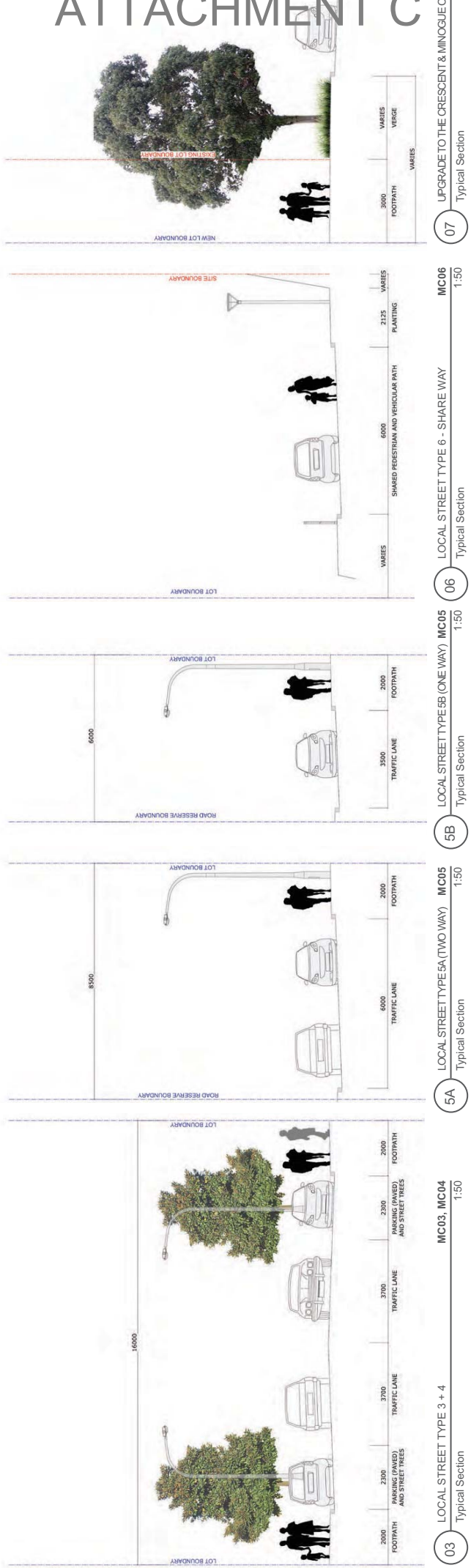

ATTACHMENT C

date: 21/06/2011
 rev: A
 1:50
 scale @ A0: 1:50
 job no: 11001
 date: 21/06/2011
 drawing no: PD-DA-013
 rev: B

client: **Harold Park**
 Glebe, NSW
 project: **Harold Park**
 Glebe, NSW
 Copyright of this design and all other information herein, owned by Mirvac Design Pty Ltd. No part of this design may be reproduced without the written consent of Mirvac Design Pty Ltd.

architects in association:
 Mirvac Design
 Level 20, 85 Murrumbidgee Street, Sydney NSW 2000
 Tel: 61 2 9268 0101
 Fax: 61 2 9268 0102
 MVR 78 200 01 95

public domain:
 ASPECT Studios
 Level 1, 100 Victoria Road, Sydney NSW 2000
 Tel: 61 2 9251 2000
 Fax: 61 2 9251 2002
 MVR 78 200 01 95

development application:
ASPECT Studios
 Level 1, 100 Victoria Road, Sydney NSW 2000
 Tel: 61 2 9251 2000
 Fax: 61 2 9251 2002
 MVR 78 200 01 95

development application:
ASPECT Studios
 Level 1, 100 Victoria Road, Sydney NSW 2000
 Tel: 61 2 9251 2000
 Fax: 61 2 9251 2002
 MVR 78 200 01 95

NOTE:
 Indicative mature trees shown at approximately 10 years after installation. Refer to Street Tree Master Plan for size at time of planting.

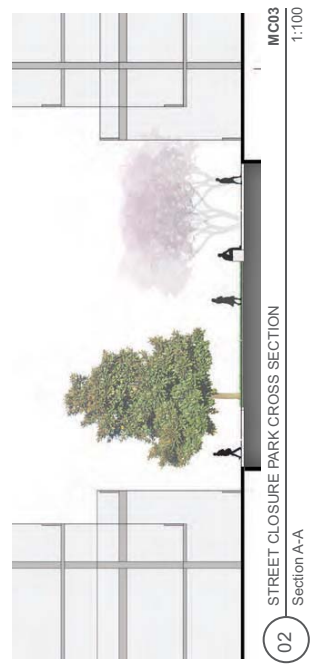
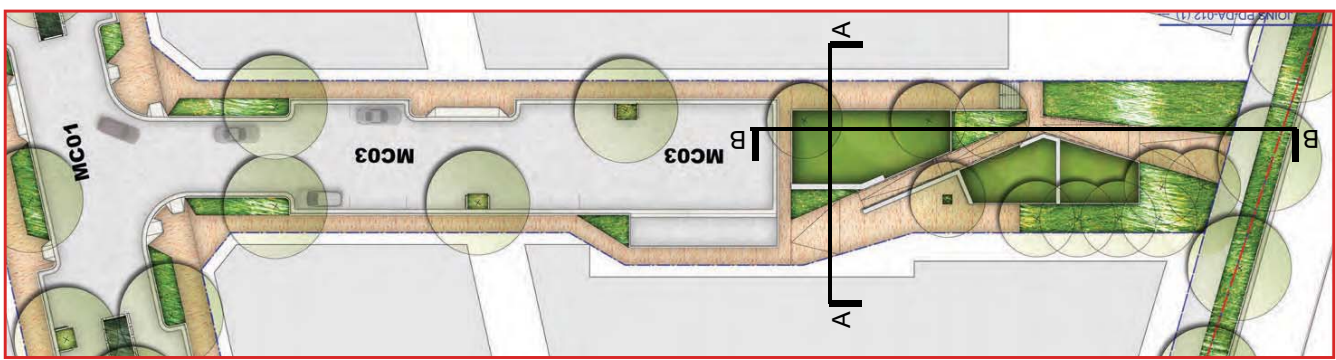
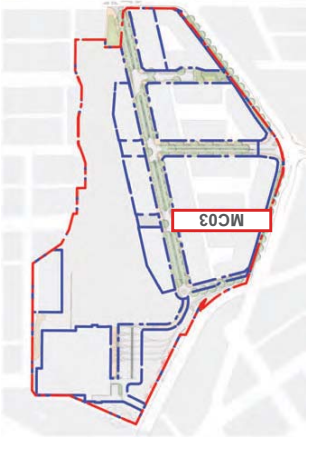

02 Section A-A



03 Section B-B

ATTACHMENT C

01 KEY PLAN OF MC03
 Plan
 NTS
 MC03

date: 09/06/2012
 author: A
 checked: U
 reviewed: C
 approved: M

project: Harold Park
 Glebe, NSW

client: mirvac

architects in association:
 Mirvac Design
 architects
 Mirvac Design
 Sydney
 NSW 2000
 Australia
 Tel: 61 2 9288 0000
 Fax: 61 2 9288 0001
 Email: info@mirvac.com.au

public domain:
 ASPECT Studios
 architects
 Sydney
 NSW 2000
 Australia
 Tel: 61 2 9288 0000
 Fax: 61 2 9288 0001
 Email: info@aspectstudios.com.au

title: Development Application
 Street closure Park
 Sections - MC03

scale @ A0: 1:100
 scale @ A1: 1:100
 drawing no: PD-DA-014
 date: 09/06/2012
 job no: 11001
 rev: F

NOTE:
Indicative mature trees shown at approximately 10 years after installation. Refer to Street Tree Master Plan for size at time of planting.

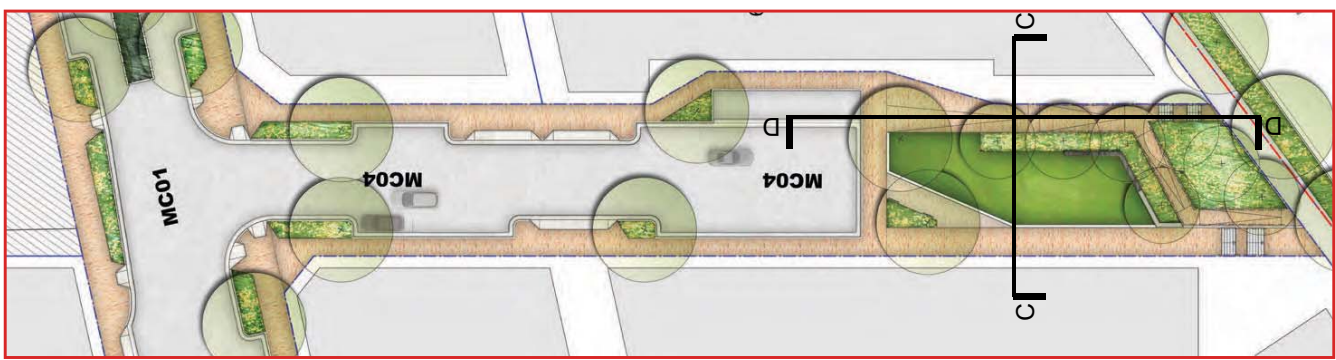
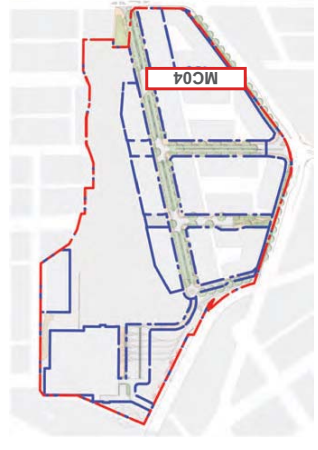

01 KEY PLAN OF MC04
Plan



02 STREET CLOSURE PARK CROSS SECTION
Section C-C
MC04
1:100

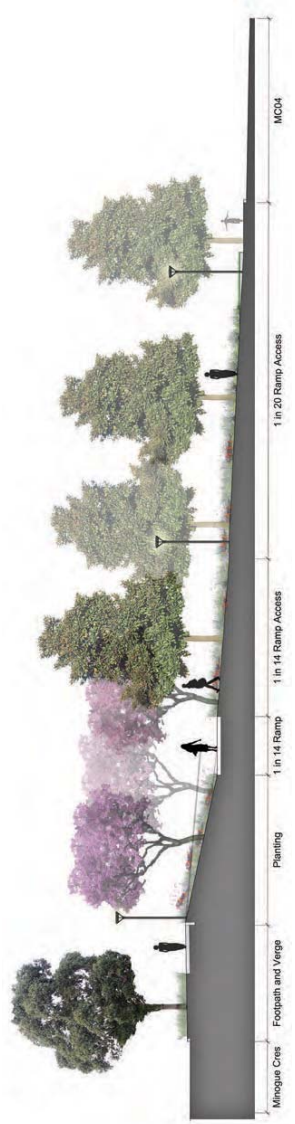

03 STREET CLOSURE PARK ELEVATION
Section D-D
MC04
1:100

ATTACHMENT C

date: 19/06/2012
rev: A
environment: DA Stage

project:
Harold Park
Glebe, NSW
the client: Harold Park Development Corporation

client:
mirvac

architects in association:
Mirvac Design
Level 20, 80 Macquarie St
Sydney NSW 2000
Tel: 61 2 9266 8311
Fax: 61 2 9266 8311
www.mirvac.com.au

public domain:
HASSELL
Landscape Architecture
Level 20, 80 Macquarie St
Sydney NSW 2000
Tel: 61 2 9266 8311
Fax: 61 2 9266 8311
www.hassell.com.au

public domain:
ASPECT Studios
Landscape Architecture
Level 20, 80 Macquarie St
Sydney NSW 2000
Tel: 61 2 9266 8311
Fax: 61 2 9266 8311
www.aspectstudios.com.au

title:
Development Application
Street closure Park
Sections - MC04

scale @ A0: 1:100
drawing no: PD-DA-015
job no: 11001
date:
rev: A

Street Furniture and Materials

01 BIKE RACK 1:10

Labels: BIKE RACK, 1/2" DIA. WELDED MILD STEEL (STANDARD) STEEL, CONCRETE FOOTING

Photo: Bicycle Rack

02 BOLLARD 1:10

Labels: BOLLARD, 1" DIA. TUBULAR GALVNEAL CONCRETE FOOTING TO MATCH SPECIFICATION DETAIL, CONCRETE FOOTING

Photo: Bollard

03 RUBBISH BIN 1:10

Labels: RUBBISH BIN, 1" DIA. WELDED MILD STEEL (STANDARD) STEEL, CONCRETE FOOTING

Photo: Rubbish Bin

04 BENCH 1:10

Labels: BENCH TO COS SPECIFICATION, CONCRETE FOOTING

Photo: Bench

05 BRICK PAVING 1:10

Labels: BRICK PAVING, 1" DIA. WELDED MILD STEEL (STANDARD) STEEL, CONCRETE FOOTING

Photo: Larger Paving and Door Footpath in surrounding platform

06 IN SITU CONCRETE PAVING 1:10

Labels: IN SITU CONCRETE PAVING, 1" DIA. WELDED MILD STEEL (STANDARD) STEEL, CONCRETE FOOTING

Photo: In situ concrete paving

07 PLANTING STRIP IN PUBLIC DOMAIN TO INTERPRET TRAM TRACK (BY OTHERS) 1:10

Labels: APPROXIMATE FOR FORMER TRAM TRACKS, CONCRETE FOOTING, PAVING STRIP INTEGRATION

Photo: Paving Strip Integration

08 BRICK PAVING IN TRACK 1:10

Labels: APPROXIMATE FOR FORMER TRAM TRACKS, CONCRETE FOOTING, PAVING STRIP INTEGRATION

Photo: Paving Strip Integration

09 PAVING STRIP IN PUBLIC DOMAIN AREAS TO INTERPRET TRAM TRACKS (BY OTHERS) 1:10

Labels: APPROXIMATE FOR FORMER TRAM TRACKS, CONCRETE FOOTING, PAVING STRIP INTEGRATION

Photo: Paving Strip Integration

10 PAVING STRIP IN TRAM SHEEDS CAR PARK TO INTERPRET TRAM TRACKS 1:10

Labels: APPROXIMATE FOR FORMER TRAM TRACKS, CONCRETE FOOTING, PAVING STRIP INTEGRATION

Photo: Paving Strip Integration

Planting Details

Indicative Understorey Plant Schedule

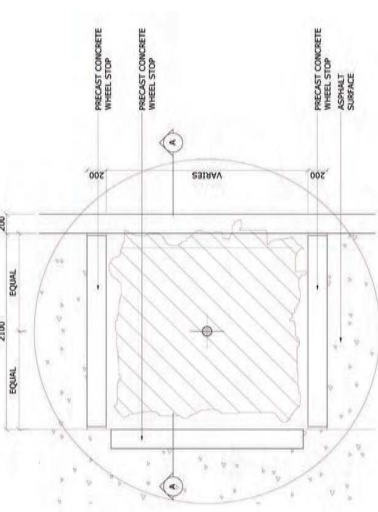

PLAN A

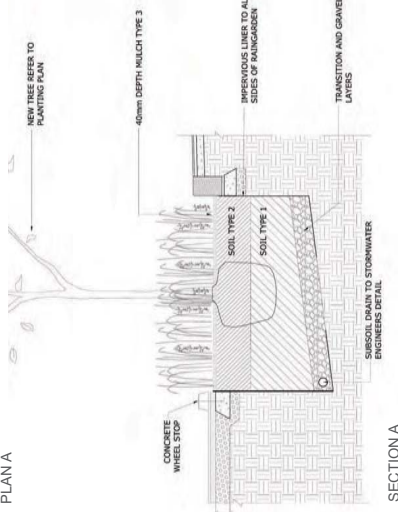

SECTION A

01 PARKING BAY RAIN GARDEN

1:20



Rain Garden Tree



SECTION B

02 SWALE

1:20

Kerb and Gutter details

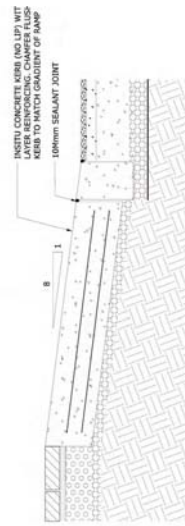

03 CONCRETE DRIVEWAY

1:20

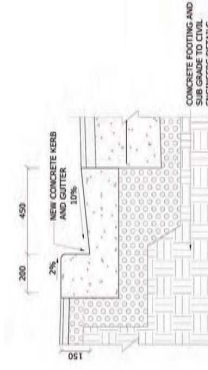

05 CONCRETE KERB AND GUTTER

1:20

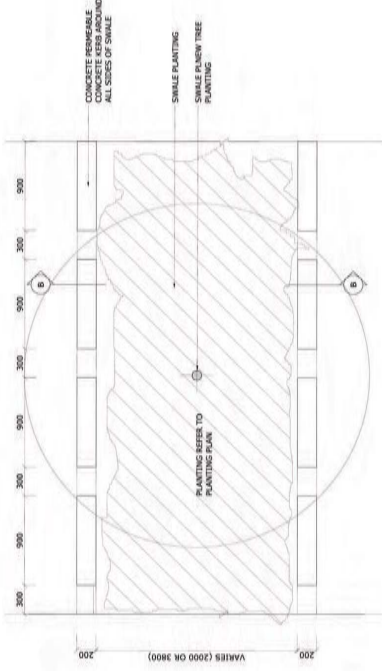

PLAN B



Swale Permeable Kerb



Indicative Plant Images

Botanical Name	Common Name	Native / Exotic	Mature Height	Pot Size
Acacia cognata 'Limelight'	Limelight Acacia	Native	1000mm	200mm
Baeckea virgata 'Compacta'	Twiggy Heath Myrtle Standard	Native	1000mm	200mm
Beschoemia yuccoides	Mexican Lily	Exotic	1000mm	200mm
Pilosporum tobira 'Miss Mufflet'	Miss Mufflet Pilosporum	Exotic	1000mm	200mm
Phibodendron 'Xanadu'	Xanadu Phibodendron	Exotic	1000mm	150mm
Raphidopsis indica 'Snow Maiden'	Snow Maiden Indian Hawthorn	Exotic	1000mm	200mm
Trachelospermum jasminoides	Chinese Star Jasmine	Exotic	500mm	150mm
Westringia fruticosa 'Mundi'	Mundi Coastal Rosemary	Native	500mm	200mm
Westringia fruticosa 'Aussie Box'	Aussie Box Coastal Rosemary	Native	600mm	200mm

